

CONSTRUCTION PLAN

SOME GRADE CHALLENGES AND ENCROACHMENTS ON THE SOUTH SIDE OF IVY ST. WOULD PUSH PROPOSED SIDEWALK CLOSER TO OR DIRECTLY BEHIND THE CURB LEAVING REDUCED OR NO BOULEVARD FOR SNOW STORAGE OR FUTURE TREE PLANTING.
 RECOMMEND SIDEWALK CONSTRUCTION ON NORTH SIDE ONLY.

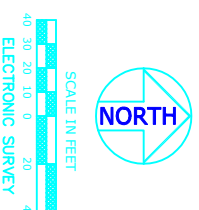
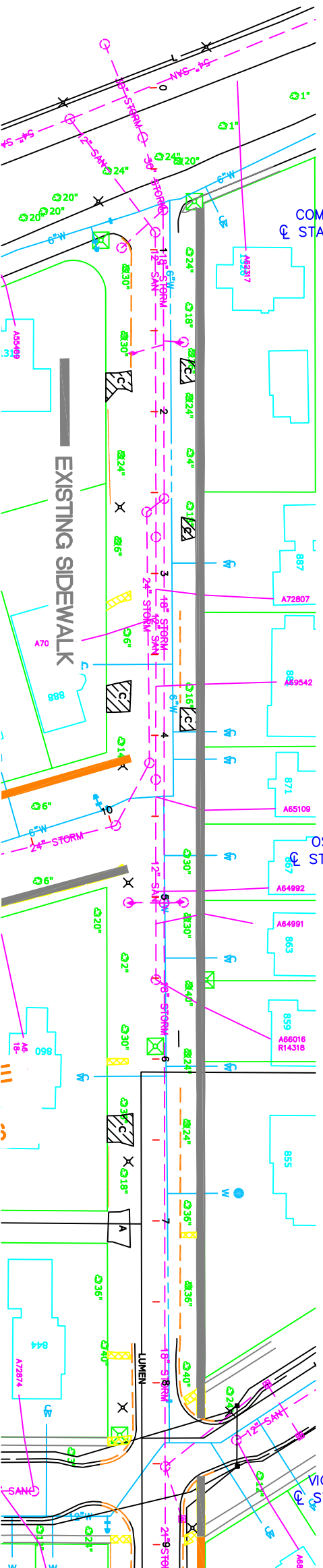
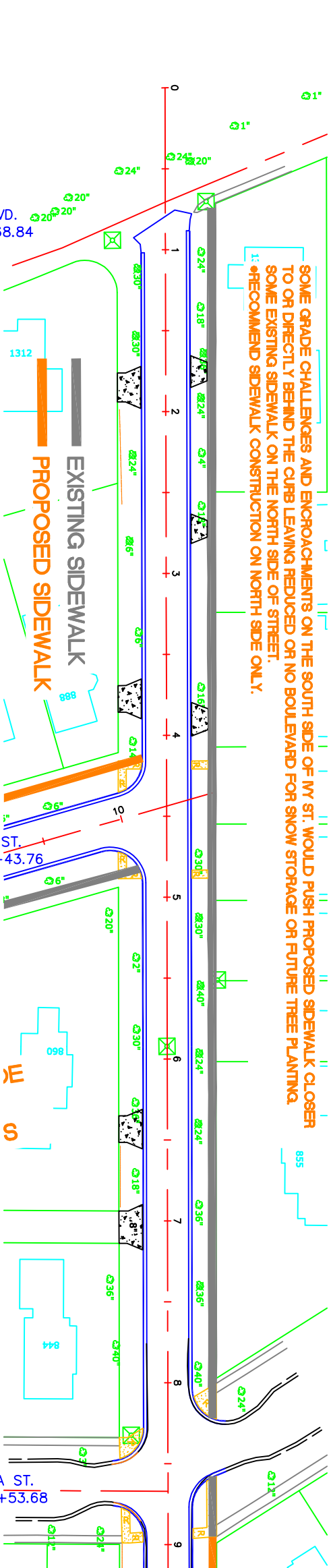

DESIGNED	CBH
DRAWN	CBH
APPROVED	BRM

Signature: _____
 Lic. No. 43099

I HEREBY CERTIFY THAT THIS PLAN WAS PREPARED BY ME OR UNDER MY DIRECT SUPERVISION AND THAT I AM A DULY LICENSED PROFESSIONAL ENGINEER UNDER THE LAWS OF THE STATE OF MINNESOTA

PREPARED BY STREET ENGINEERING DIVISION FOR THE CITY OF ST. PAUL, DEPARTMENT OF PUBLIC WORKS

PROJECT:	25-P-8186
DRAWER:	12
DATE:	2/6/2025
PROJECT NAME:	PROJECTS/CURRENT/WHEELLOCK GROTTO/DWG
STATE AID PROJECT NUMBER:	
DWG. NO.	1658
DATE:	2/6/2025
SHEET NO.	22 OF XX SHEETS



IVY AVENUE
 Como to Victoria

WHEELLOCK-GROTTO PHASE 1

EXISTING AND REMOVAL PLAN