

# L14 SINGLE LANTERN STANDARD DETAIL-ALTERNATE

ST PAUL PATINA  
GREEN COLOR

BLACK COLOR

HOLOPHANE ARLINGTON POSTTOP  
OR EQUIVALENT  
IN 70W/100W EQ. OUTPUT

16"  
CAPITOL ON  
4"X14"  
TENON

ST PAUL  
BROWN COLOR

145.5"

17'

NO SCALE

### SECTION A-A

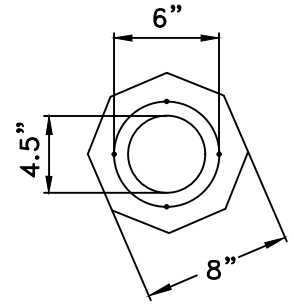

### SECTION B-B SLOTS FOR 1" BOLTS ON 15" BOLT CIRCLE

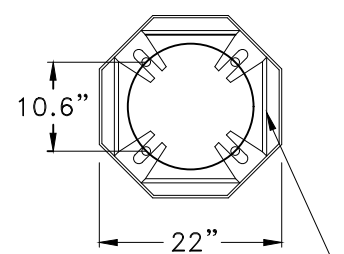

OCTAL BASE  
ANCHOR RING

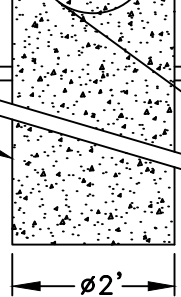
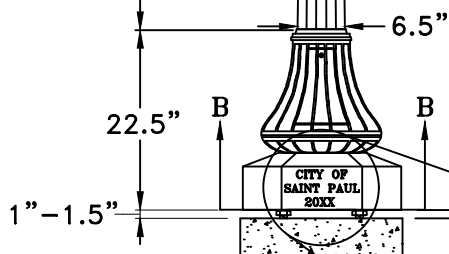

FOR FOUNDATION DETAIL  
SEE ST PAUL STANDARD  
SHEET 5008

I hereby certify that this plan, specification or report was prepared by me or under my direct supervision and that I am a duly Licensed Professional Engineer under the laws of the State of Minnesota.

*B. Hawkins*  
BENJAMIN J. HAWKINS

Date: 11/15/2024 Lic. No. 49104

APPROVED

CITY ENGINEER

CITY OF ST PAUL DEPARTMENT OF PUBLIC WORKS  
L14 LANTERN STANDARD DETAIL-  
ALTERNATE

DATE OF REVISION:  
NOVEMBER 2024

STANDARD PLATE NO.  
5057A  
SHEET 1 OF 2

# L14 SINGLE LANTERN STANDARD DETAIL-ALTERNATE (CROSS-SECTION VIEW)

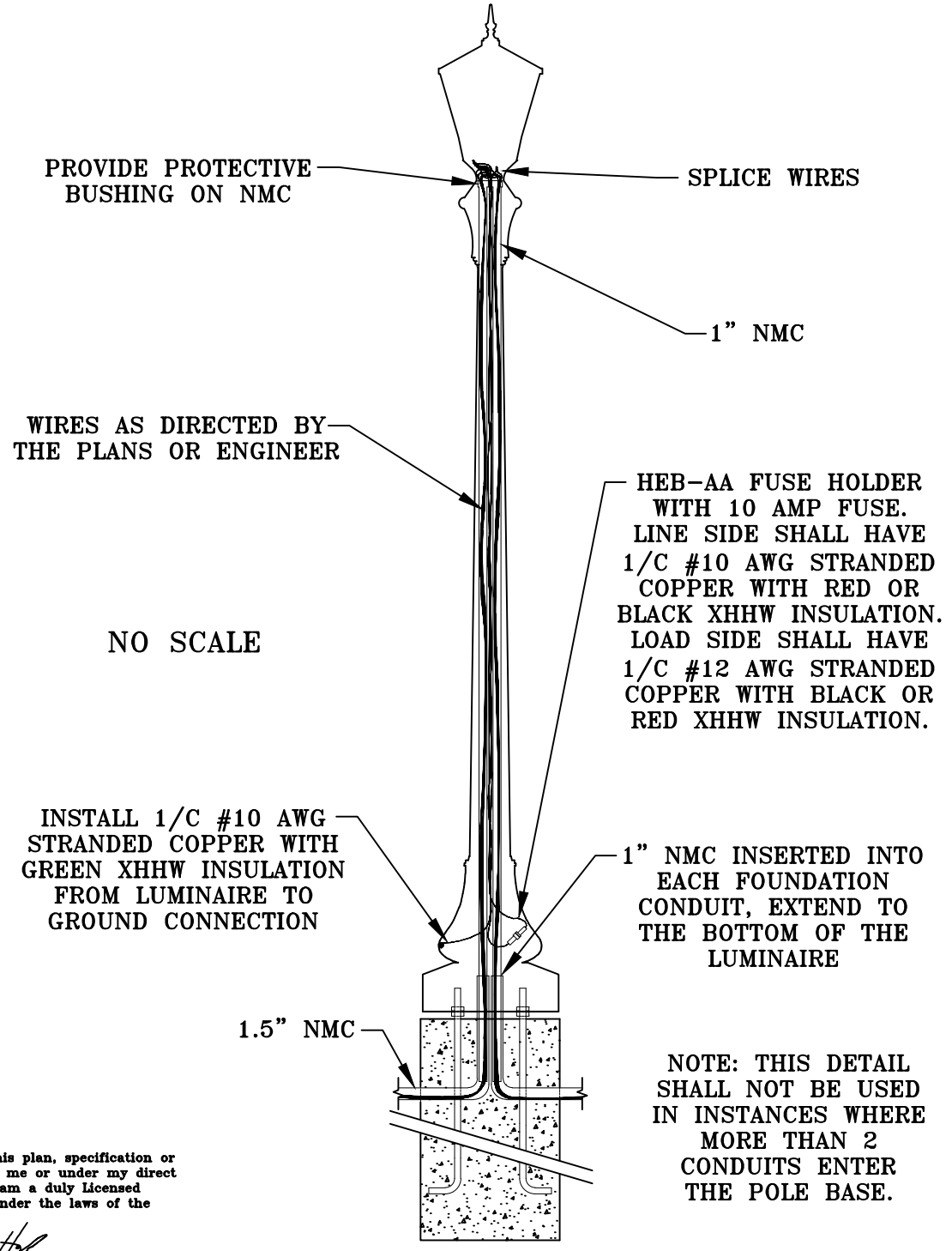

WIRES AS DIRECTED BY THE PLANS OR ENGINEER

NO SCALE

INSTALL 1/C #10 AWG STRANDED COPPER WITH GREEN XHHW INSULATION FROM LUMINAIRE TO GROUND CONNECTION

HEB-AA FUSE HOLDER WITH 10 AMP FUSE. LINE SIDE SHALL HAVE 1/C #10 AWG STRANDED COPPER WITH RED OR BLACK XHHW INSULATION. LOAD SIDE SHALL HAVE 1/C #12 AWG STRANDED COPPER WITH BLACK OR RED XHHW INSULATION.

1" NMC INSERTED INTO EACH FOUNDATION CONDUIT, EXTEND TO THE BOTTOM OF THE LUMINAIRE

NOTE: THIS DETAIL SHALL NOT BE USED IN INSTANCES WHERE MORE THAN 2 CONDUITS ENTER THE POLE BASE.

I hereby certify that this plan, specification or report was prepared by me or under my direct supervision and that I am a duly Licensed Professional Engineer under the laws of the State of Minnesota.

*B. Hawkins*  
BENJAMIN J. HAWKINS

Date: 11/15/2024 Lic. No. 49104

APPROVED  
  
CITY ENGINEER

CITY OF ST PAUL DEPARTMENT OF PUBLIC WORKS  
L14 LANTERN STANDARD DETAIL-  
ALTERNATE

DATE OF REVISION:  
NOVEMBER 2024

STANDARD PLATE NO. 5057A  
SHEET 2 OF 2