

L10 SINGLE LANTERN STANDARD DETAIL-ALTERNATE

ST PAUL PATINA
GREEN COLOR

BLACK COLOR

HOLOPHANE ARLINGTON POSTTOP
OR EQUIVALENT
IN 70W/100W EQ. OUTPUT

16"
CAPITOL ON
4"X14"
TENON

ST PAUL
BROWN COLOR

SECTION A-A

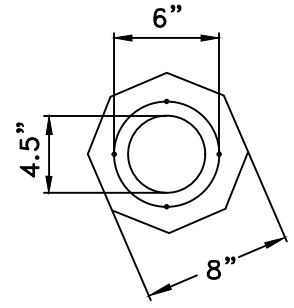

98.5"

13'

SECTION B-B
SLOTS FOR 1" BOLTS
ON 15" BOLT CIRCLE

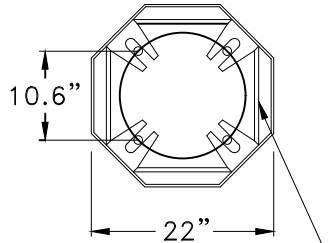

NO SCALE

6.5"

22.5"

OCTAL BASE
ANCHOR RING

1" - 1.5"

FOR FOUNDATION DETAIL
SEE ST PAUL STANDARD
SHEET 5008

I hereby certify that this plan, specification or report was prepared by me or under my direct supervision and that I am a duly Licensed Professional Engineer under the laws of the State of Minnesota.

B. Hawkins
BENJAMIN J. HAWKINS

Date: 11/15/2024 Lic. No. 49104

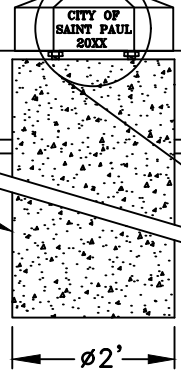

APPROVED

CITY ENGINEER

CITY OF ST PAUL DEPARTMENT OF PUBLIC WORKS
L10 LANTERN STANDARD DETAIL-
ALTERNATE

DATE OF REVISION:
NOVEMBER 2024

STANDARD PLATE NO. 5056A
SHEET 1 OF 2

L10 SINGLE LANTERN STANDARD DETAIL-ALTERNATE (CROSS-SECTION VIEW)

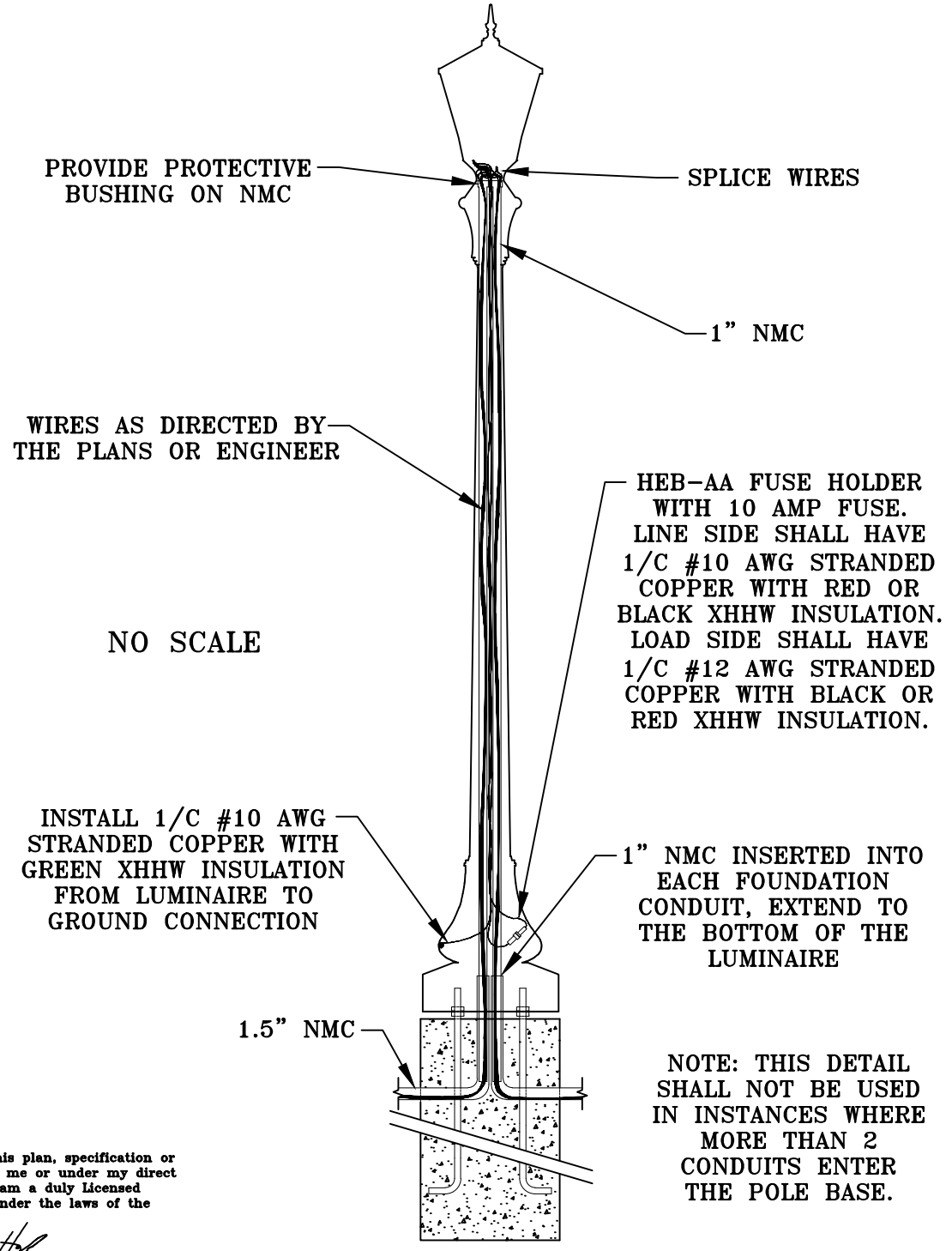

I hereby certify that this plan, specification or report was prepared by me or under my direct supervision and that I am a duly Licensed Professional Engineer under the laws of the State of Minnesota.

B. Hawkins
BENJAMIN J. HAWKINS

Date: 11/15/2024 Lic. No. 49104

APPROVED

CITY ENGINEER

CITY OF ST PAUL DEPARTMENT OF PUBLIC WORKS
L10 LANTERN STANDARD DETAIL-
ALTERNATE

DATE OF REVISION:
NOVEMBER 2024

STANDARD PLATE NO.
5056A
SHEET 2 OF 2