

TREE PROTECTION DETAIL

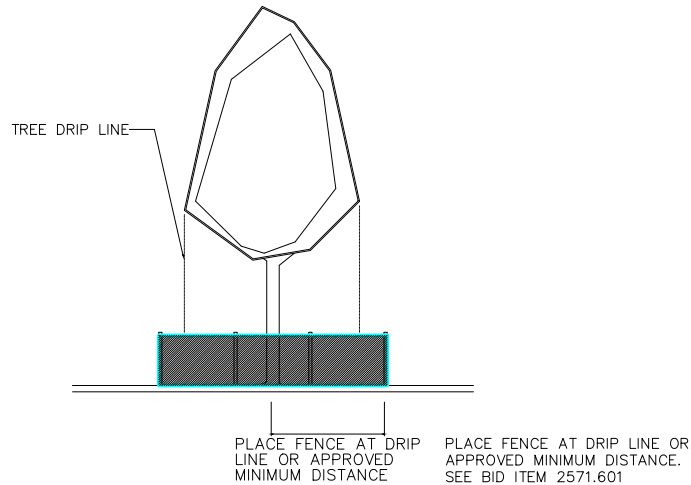
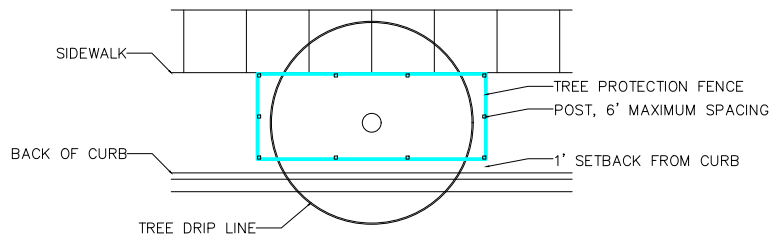

NOTES:

1. TREE PROTECTION FENCING SHALL BE INSTALLED, ACCORDING TO PLAN, PRIOR TO DEMOLITION OR OTHER SITE WORK. CONTACT CITY FORESTER (651.266.6400) PRIOR TO ANY RELOCATION OF THE TREE PROTECTION FENCING TO BE APPROVED BY CITY FORESTER. TREE PROTECTION FENCING SHALL BE MAINTAINED FOR THE DURATION OF THE CONSTRUCTION PROCESS.
2. CONSTRUCTION MATERIALS, STOCKPILES, EQUIPMENT, VEHICLES, AND TEMPORARY FACILITIES SHALL NOT BE STORED OR OPERATED WITHIN THE TREE PROTECTION ZONE.
3. ROOTS OUTSIDE OF THE TREE PROTECTION ZONE EXPOSED OR DAMAGED DURING EXCAVATION OR OTHER CONSTRUCTION ACTIVITY SHALL BE CLEANLY CUT AS DIRECTED BY THE CITY FORESTER.
4. ADDITIONAL TREE PROTECTION MEASURES MAY BE REQUIRED.
5. LIMIT GRADING WITHIN THE DRIP LINE OF EXISTING TREES, GRADING WITHIN 5' OF THE TRUNK OF TREE SHALL BE DONE BY HAND OR SMALL EQUIPMENT TO MINIMIZE DAMAGE TO TREE ROOTS.
6. SUPPLEMENTAL WATER IS TO BE PROVIDED DURING PERIODS OF DRY AND HOT WEATHER, TYPICALLY WHEN RAINFALL IS BELOW 1" PER WEEK.
7. SOIL COMPACTION WITHIN THE DRIP LINE OF A STREET TREE, DUE TO CONSTRUCTION ACTIVITIES, TO BE RESTORED TO THE SATISFACTION OF, AND AT NO COST TO, THE CITY.
8. EXISTING STREET TREES ARE TO BE PROTECTED AT ALL TIMES. TREES DAMAGED OR REMOVED DURING CONSTRUCTION SHALL BE RESTORED OR REPLACED TO THE SATISFACTION OF, AND AT NO COST TO, THE CITY AS DETERMINED BY THE FORESTRY MANAGER. THE CONTRACTOR IS ADVISED TO DOCUMENT PRE-EXISTING CONDITIONS PRIOR TO THE START OF CONSTRUCTION.