



STPAUL.GOV



CITY OF SAINT PAUL PUBLIC WORKS
October 8, 2024

Wheelock/Grotto Sidewalks



WHEELOCK/GROTTO PHASE 1

Phase 1 to begin construction in early summer of 2025, to be completed by November of 2025.

Existing sidewalks on Avon, Folsom, East Como Blvd. to be replaced as necessary.

New sidewalks are proposed on Parkview, Ivy, Orange, Osage.

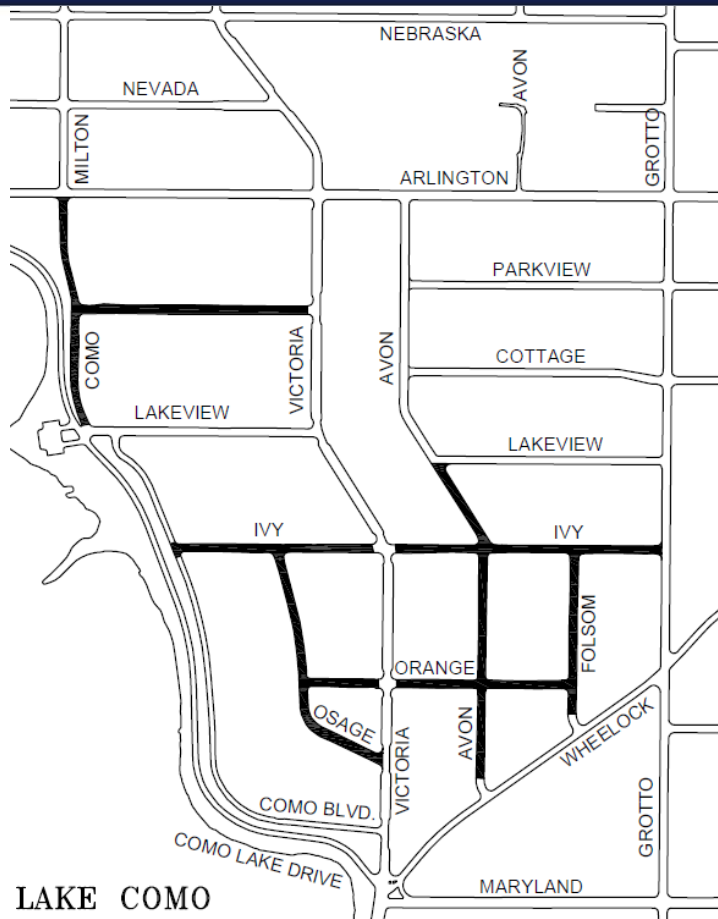

LAKE COMO



WHEELOCK/GROTTO

SAINT PAUL SIDEWALK POLICY

Paving projects strive to implement council approved policies. Sidewalk policy was passed in 2017, recommending sidewalks on both sides of an improved street.

<https://www.stpaul.gov/sites/default/files/2024-06/2017%20Street%20Reconstruction%20Sidewalk%20Infill%20Policy.pdf>

The project will meander new sidewalk as recommended by St. Paul Forestry to minimize impacts to mature trees.



WHEELOCK/GROTTO

SAFE ROUTES TO SCHOOL RECOMMENDATIONS

Project will strive to implement Safe Routes to Schools infill recommendations north of Maryland, east of Como Blvd.

For more information about the Como Safe Routes to School Plan:

<https://www.stpaul.gov/sites/default/files/2023-09/Como-Park-SRTS-Plan.pdf>

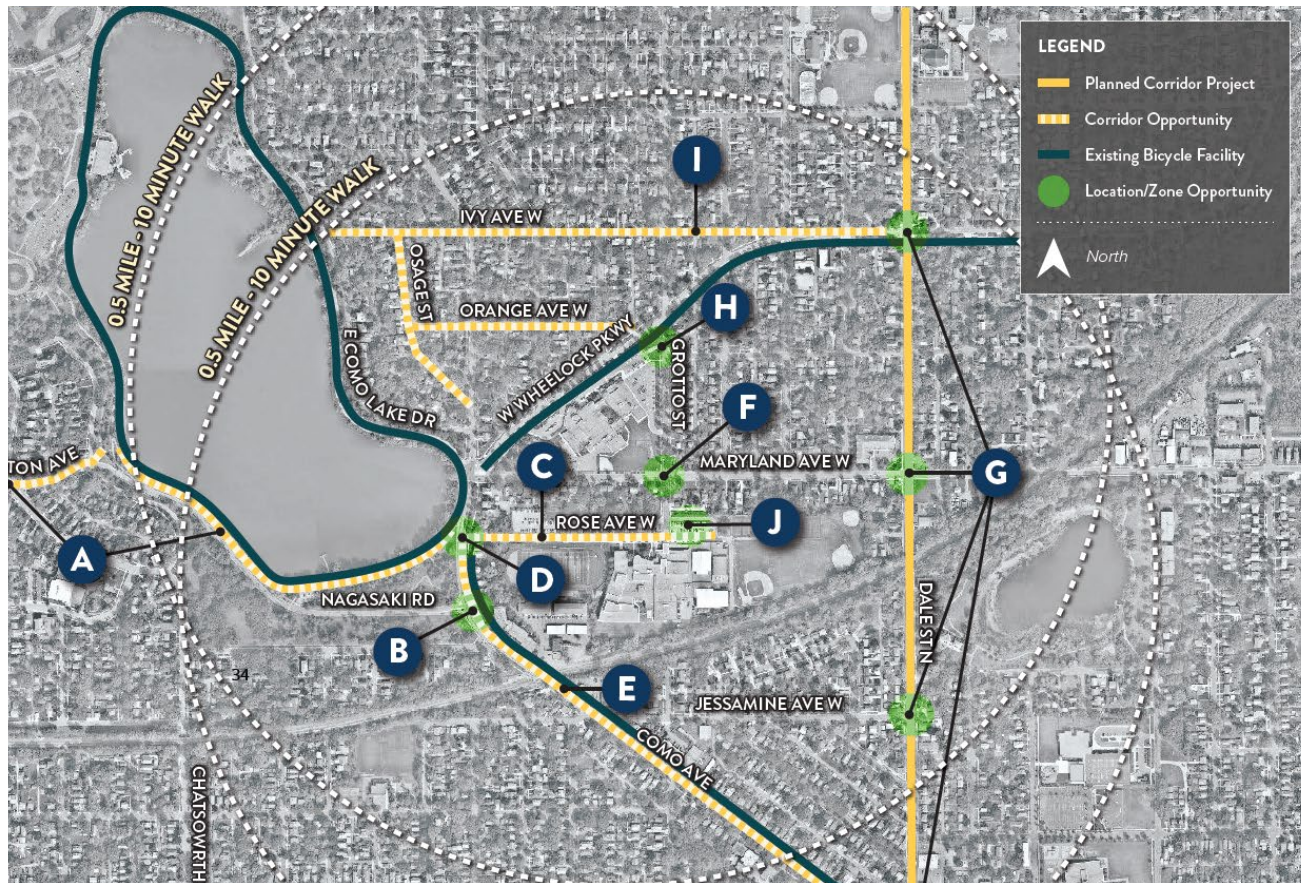



WHEELOCK GROTTO EXISTING TYPICAL SECTION

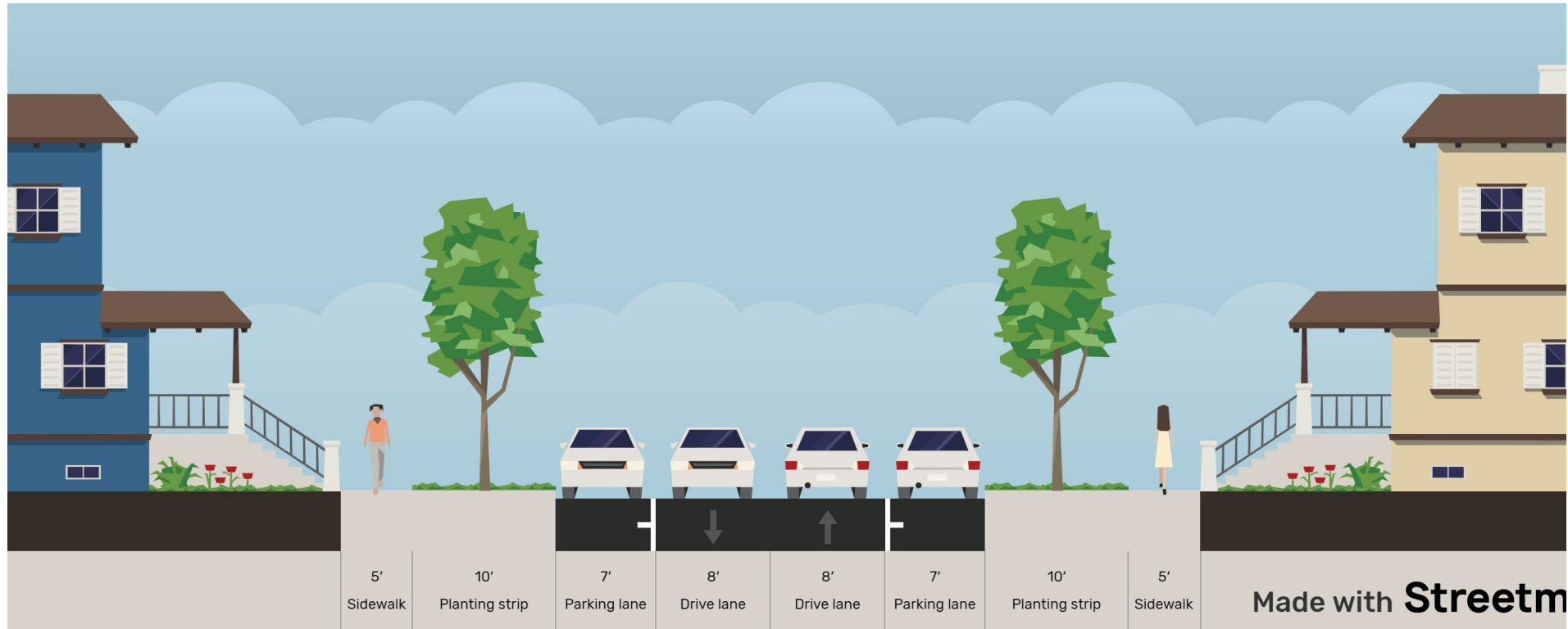



IVY AVENUE PROPOSED SIDEWALKS

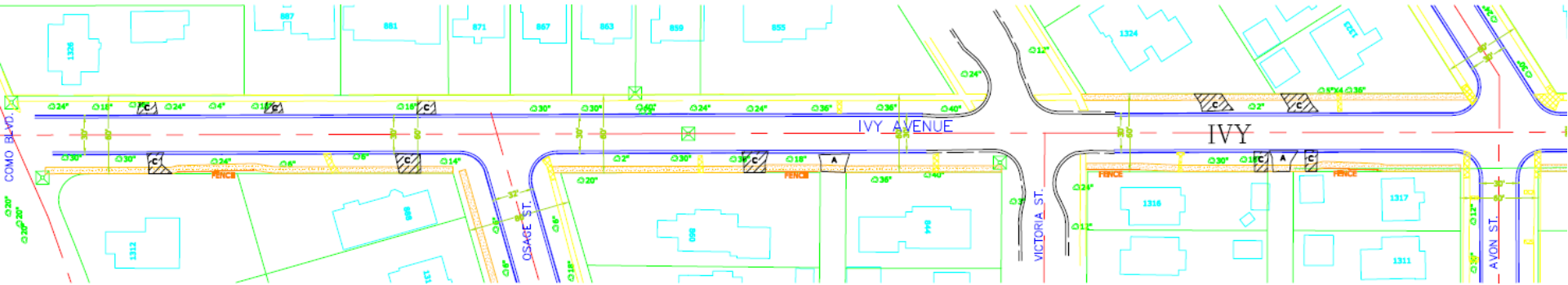

LEGEND

- RECORDED RIGHT OF WAY
- EXISTING SIDEWALK
- EXISTING FENCE OR WALL
- 12" EXISTING TREE
- PROPOSED CURB
- PROPOSED SIDEWALK



IVY AVENUE PROPOSED SIDEWALKS

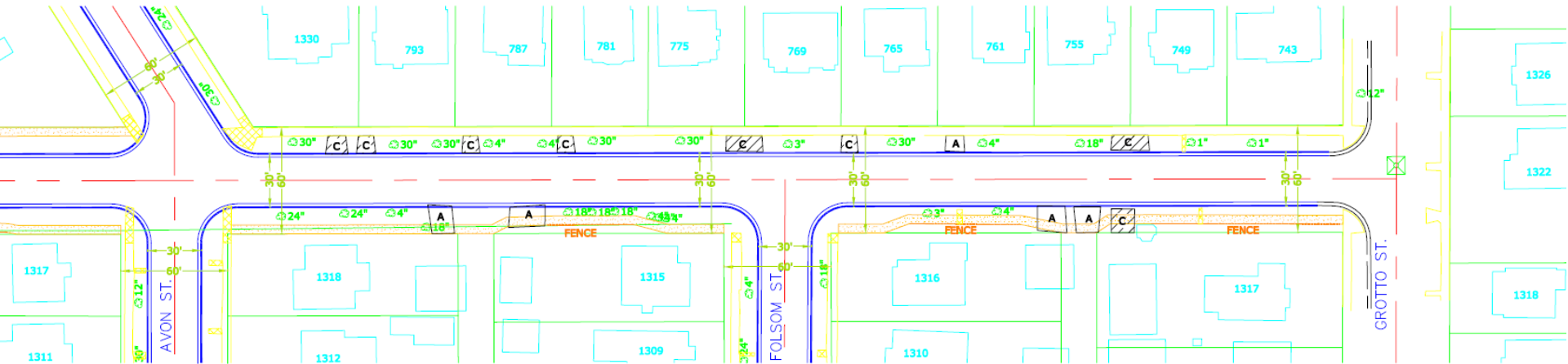

LEGEND

- RECORDED RIGHT OF WAY
- EXISTING SIDEWALK
- EXISTING FENCE OR WALL
- ⊗ 12" EXISTING TREE
- PROPOSED CURB
- PROPOSED SIDEWALK



ORANGE AVENUE PROPOSED SIDEWALKS

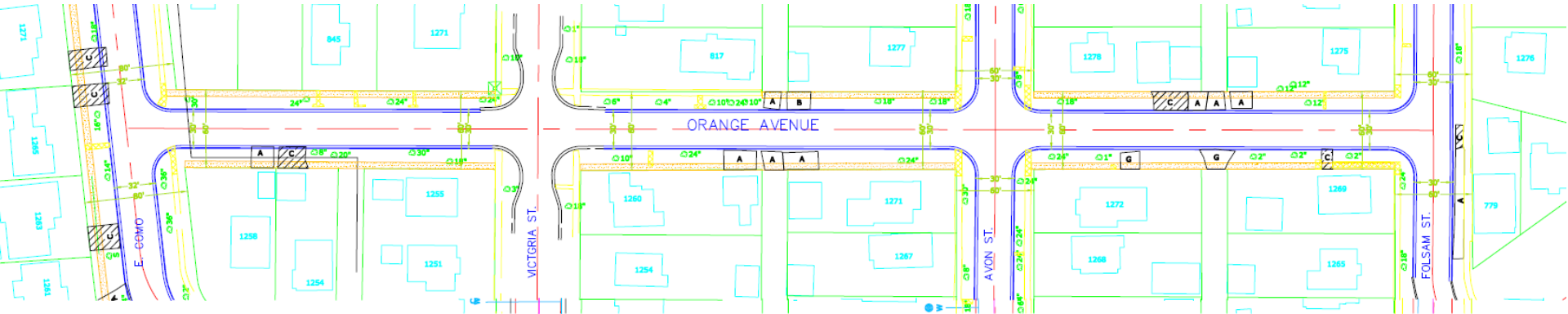

LEGEND

- RECORDED RIGHT OF WAY
- EXISTING SIDEWALK
- EXISTING FENCE OR WALL
- 🌳 12" EXISTING TREE
- PROPOSED CURB
- PROPOSED SIDEWALK



E. COMO BLVD. EXISTING TYPICAL SECTION

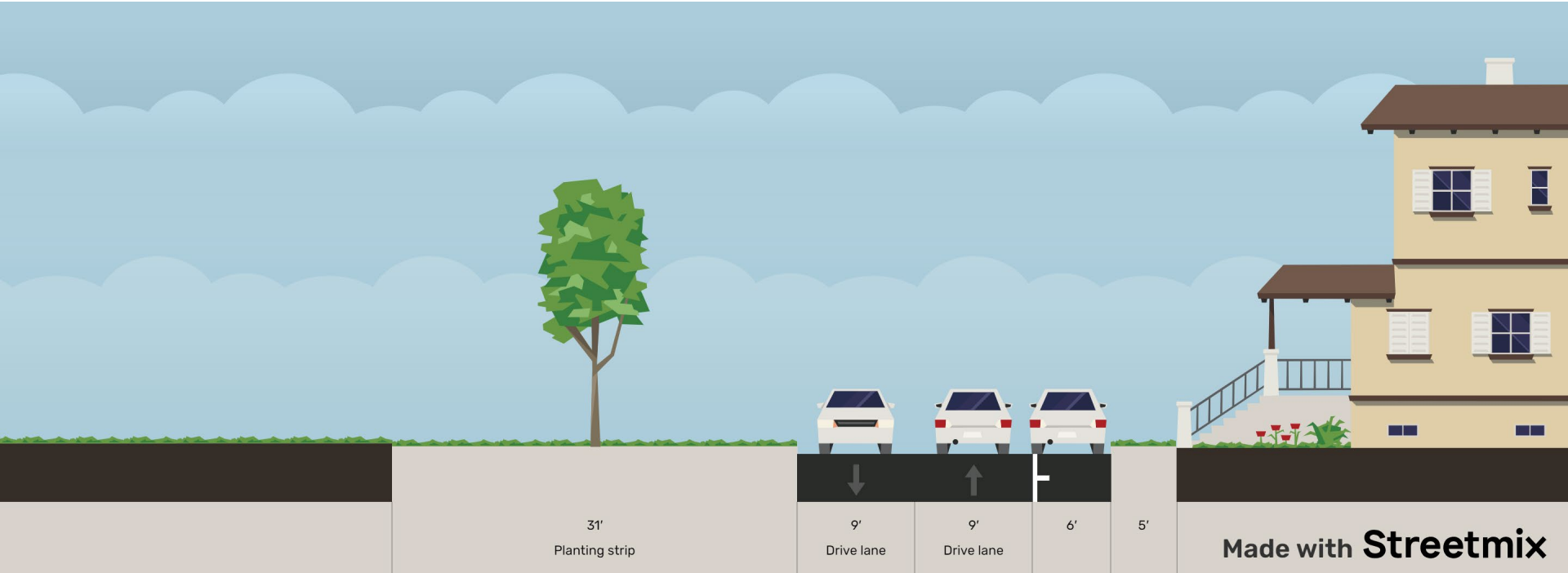



E. COMO BLVD. PROPOSED TYPICAL SECTION

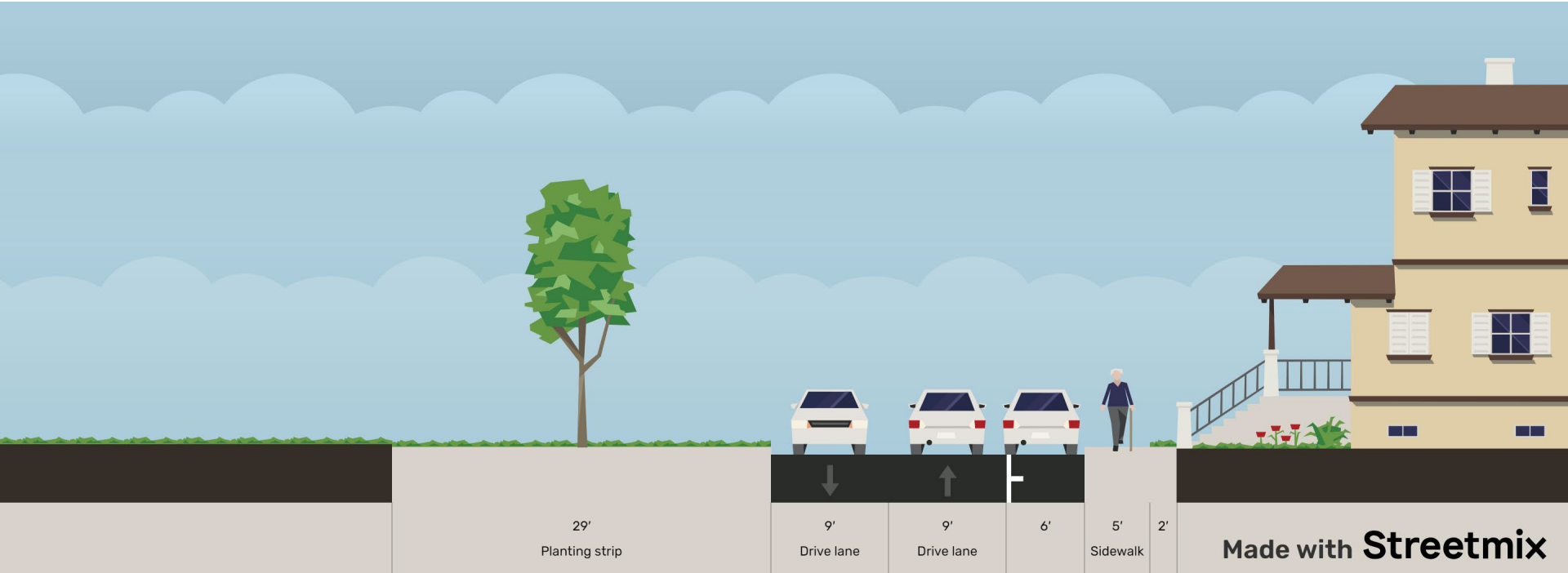



E. COMO BLVD. PROPOSED SIDEWAKS

LEGEND

- RECORDED RIGHT OF WAY
- EXISTING SIDEWALK
- EXISTING FENCE OR WALL
- 12" EXISTING TREE
- PROPOSED CURB
- PROPOSED SIDEWALK

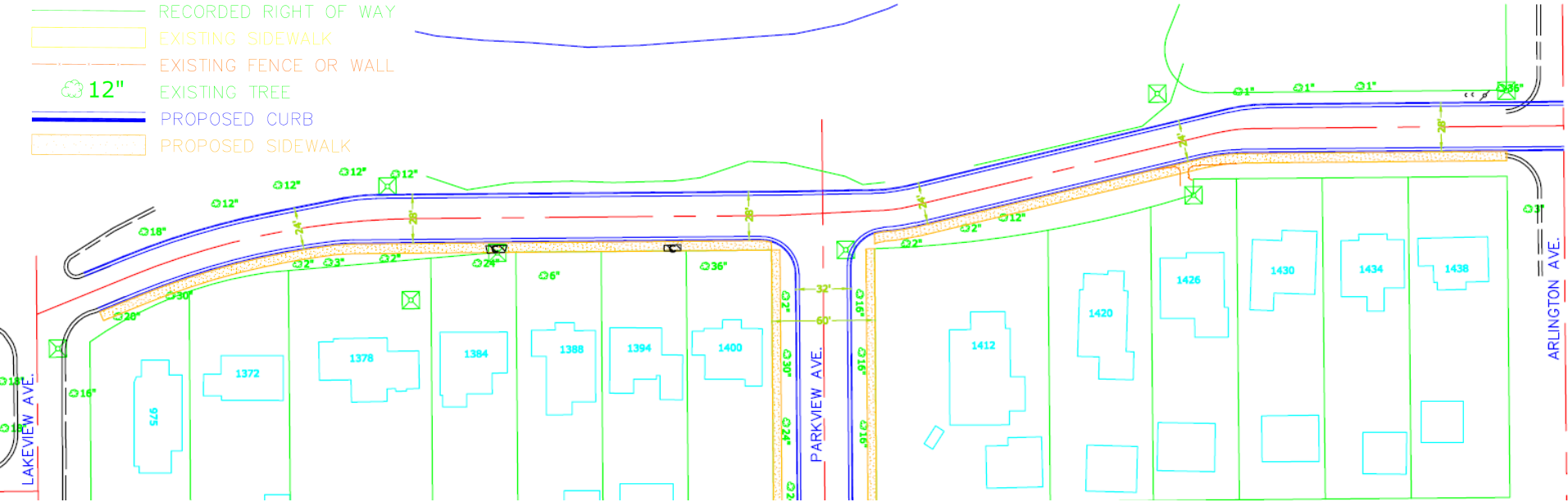



OSAGE STREET EXISTING TYPICAL SECTION

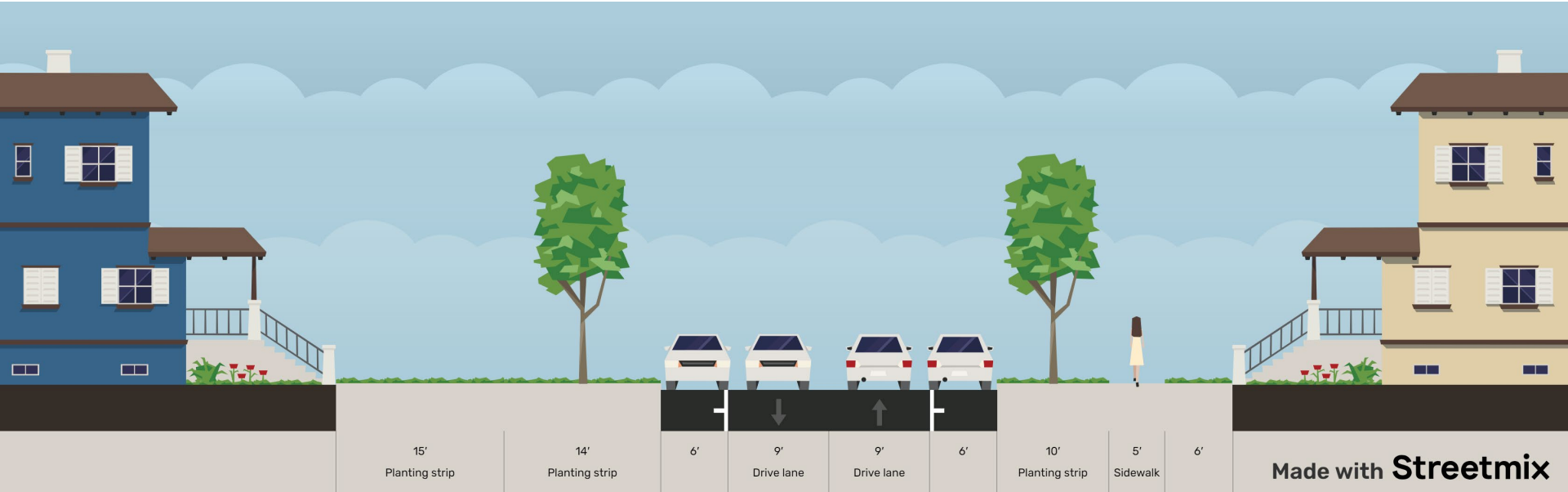



OSAGE STREET EXISTING TYPICAL SECTION

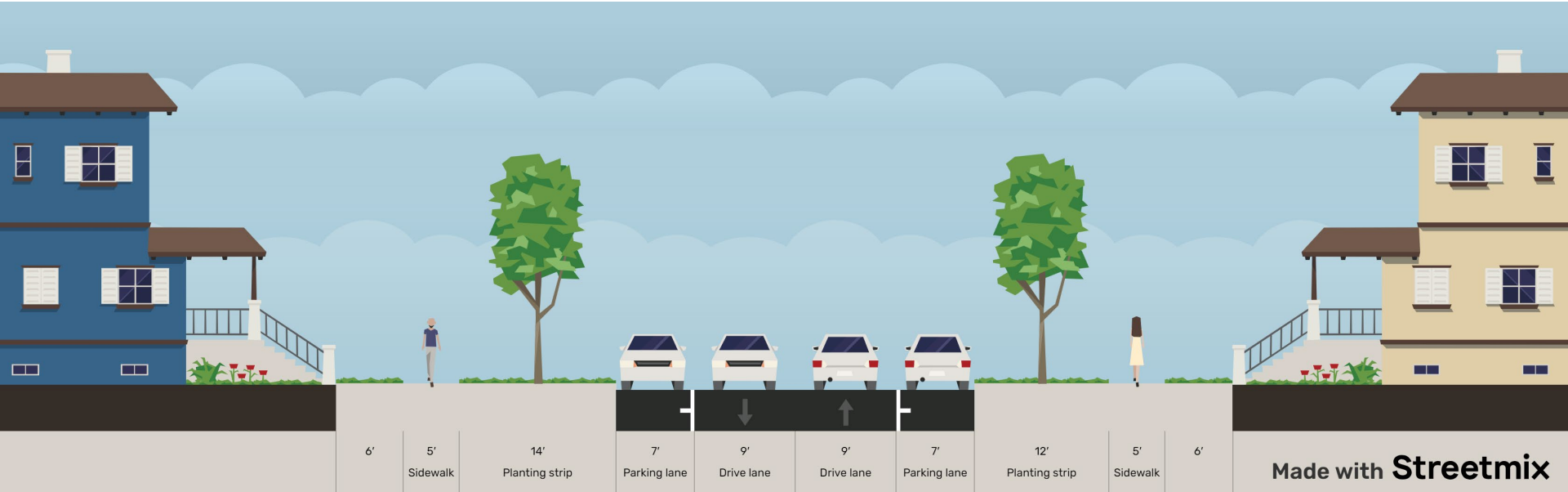



OSAGE STREET PROPOSED SIDEWALKS

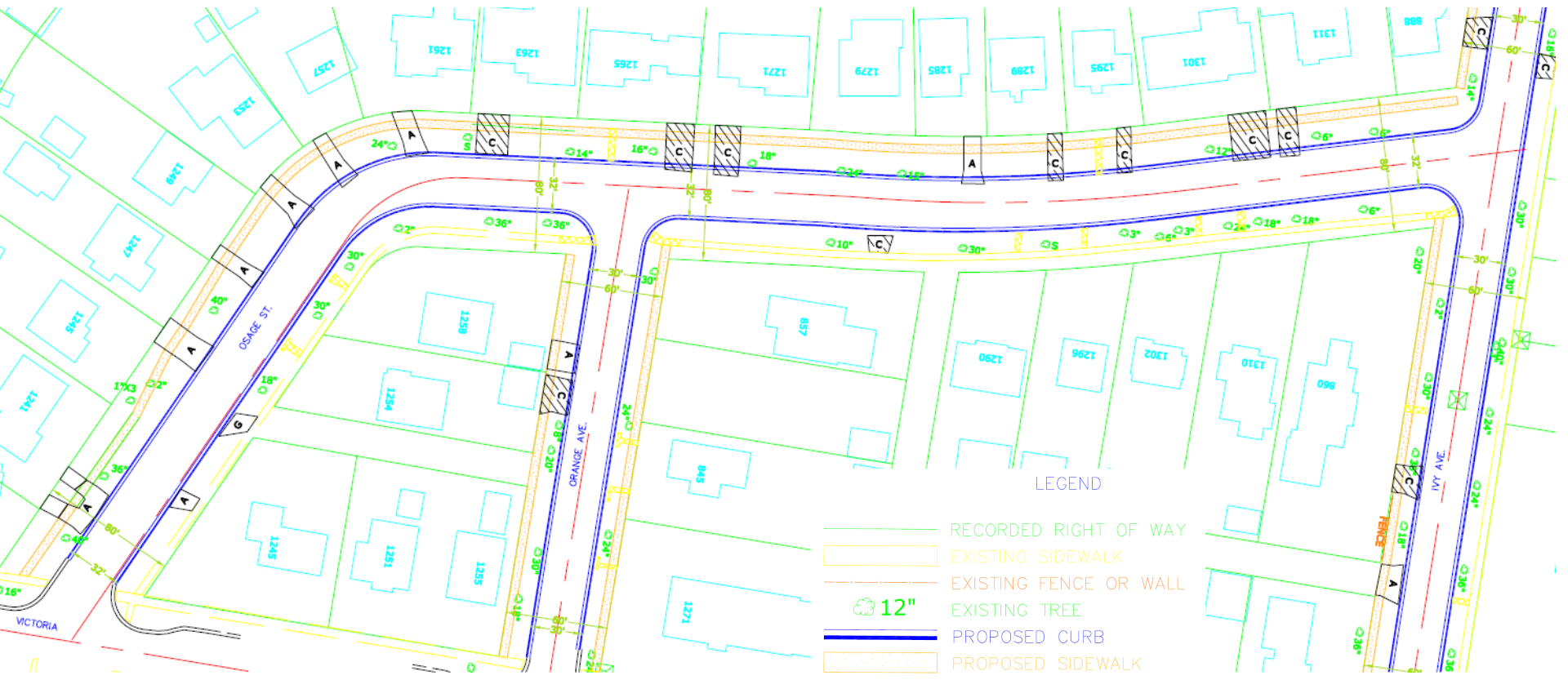



Contacts for Wheelock Parkway Reconstruction

Project Manager	Barb Mundahl	651-266-6112
Project Inspector	Brad Mikiska	651-266-6062
Public Works Street Lighting	General Line	651-266-6200
Parks and Recreation	Forestry Unit	651-266-6400
SPRWS (Water)	Service Desk	651-266-6270
Public Works Sewers	Utility Permit Desk	651-266-6234
Real Estate Section - Assessments	General Line	651-266-8858