

FROM FORD DRAWING MI-PLANT LAYOUT
DATED 6-4-90

* LOCATION FROM 1985 AERIAL PHOTO

CRA

2853-17/08/90-M

MN-COMP 0044575

figure 1.2
LOCATION OF INVESTIGATION AREAS
Ford Motor Company

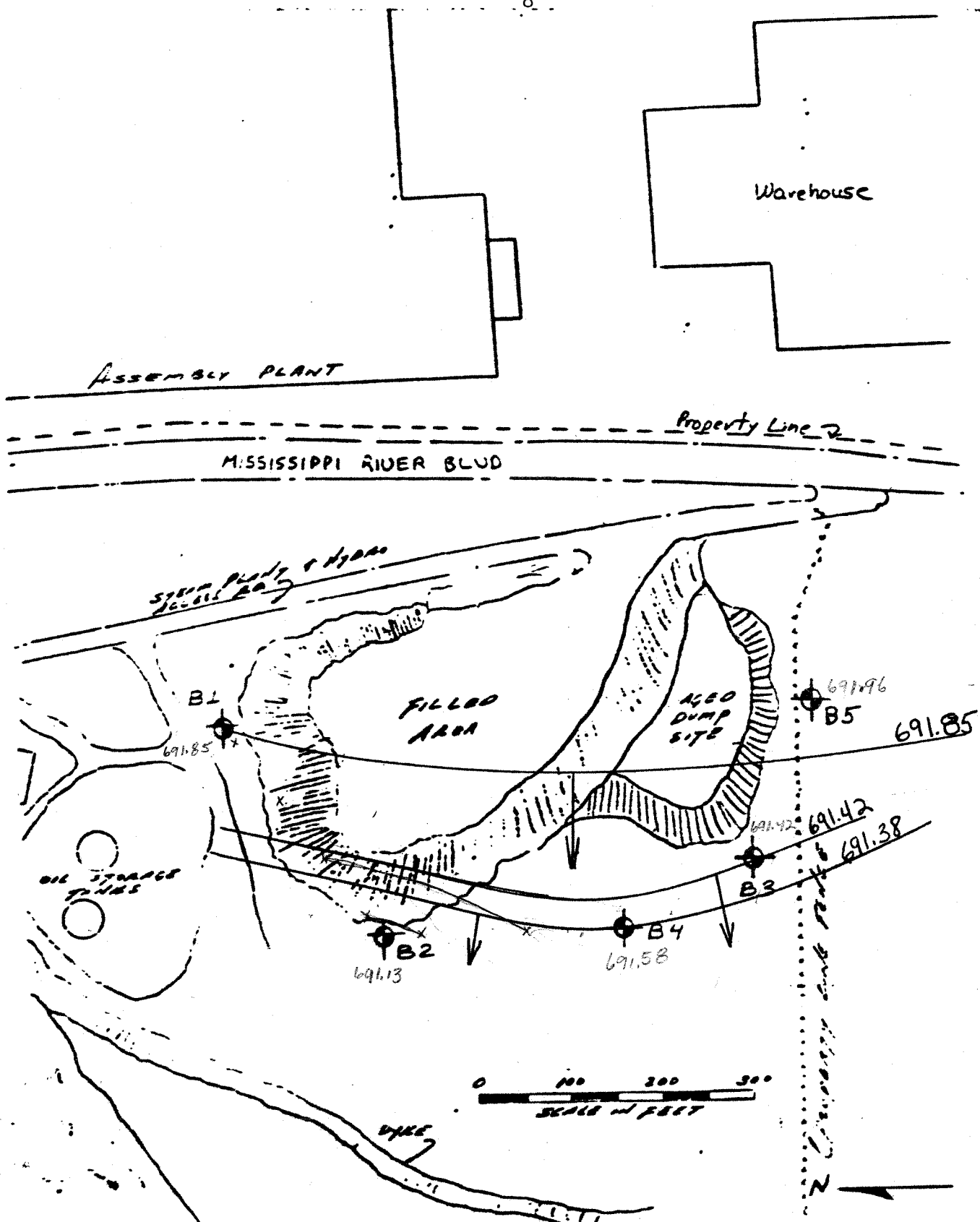

FIGURE 2
 Twin Cities Assembly Plant
 Ground Water Elevations And Flow Direction

MN-COMP 0043747

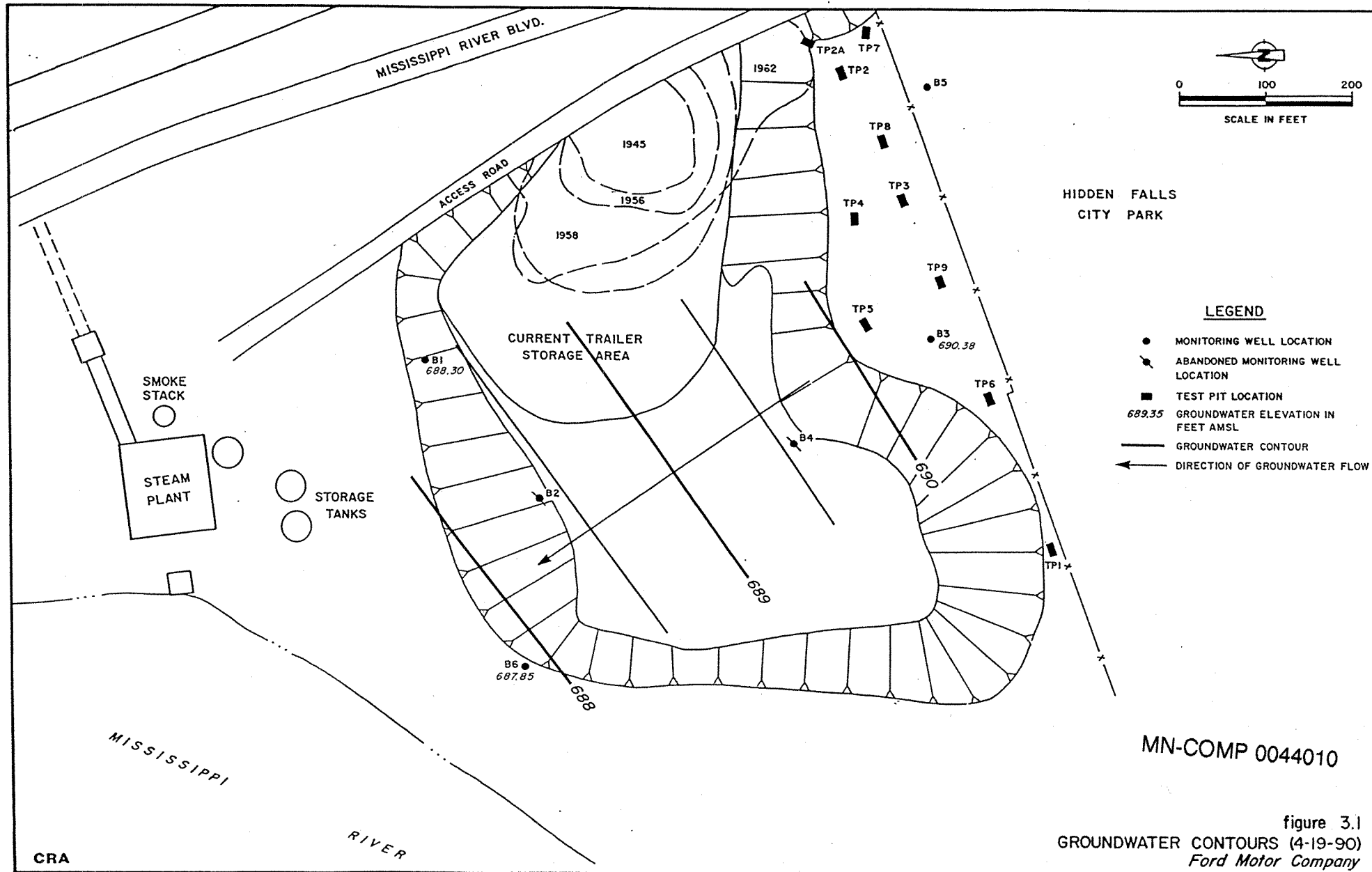

figure 3.1
GROUNDWATER CONTOURS (4-19-90)
Ford Motor Company