

# BUILDING A BETTER COMMUNITY THROUGH BUILDING CODES

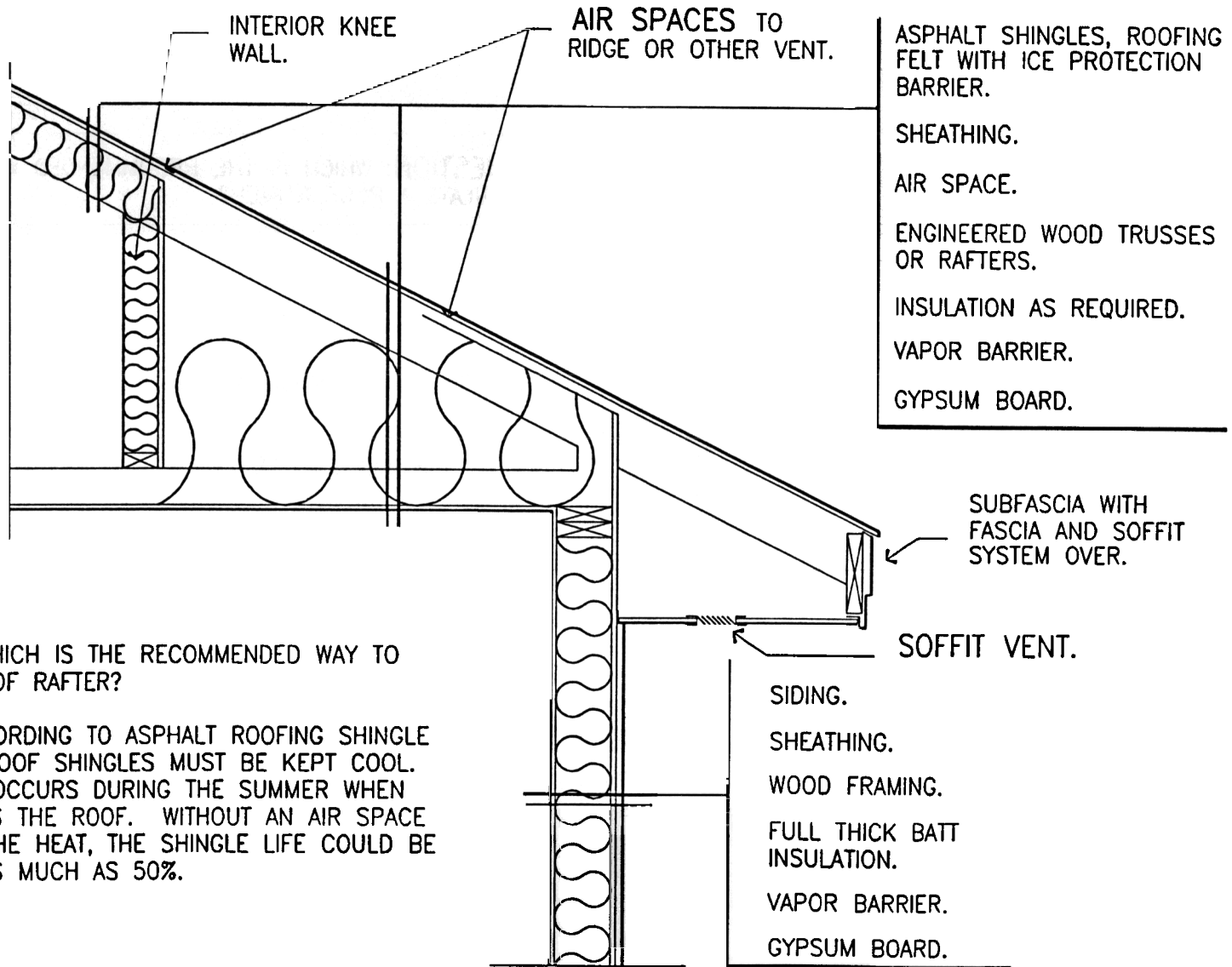

QUESTION: WHICH IS THE RECOMMENDED WAY TO INSULATE A ROOF RAFTER?

ANSWER: ACCORDING TO ASPHALT ROOFING SHINGLE MAKERS, THE ROOF SHINGLES MUST BE KEPT COOL. MOST DAMAGE OCCURS DURING THE SUMMER WHEN THE SUN BAKES THE ROOF. WITHOUT AN AIR SPACE TO DISSIPATE THE HEAT, THE SHINGLE LIFE COULD BE REDUCED BY AS MUCH AS 50%.

# BUILDING A BETTER COMMUNITY THROUGH BUILDING CODES

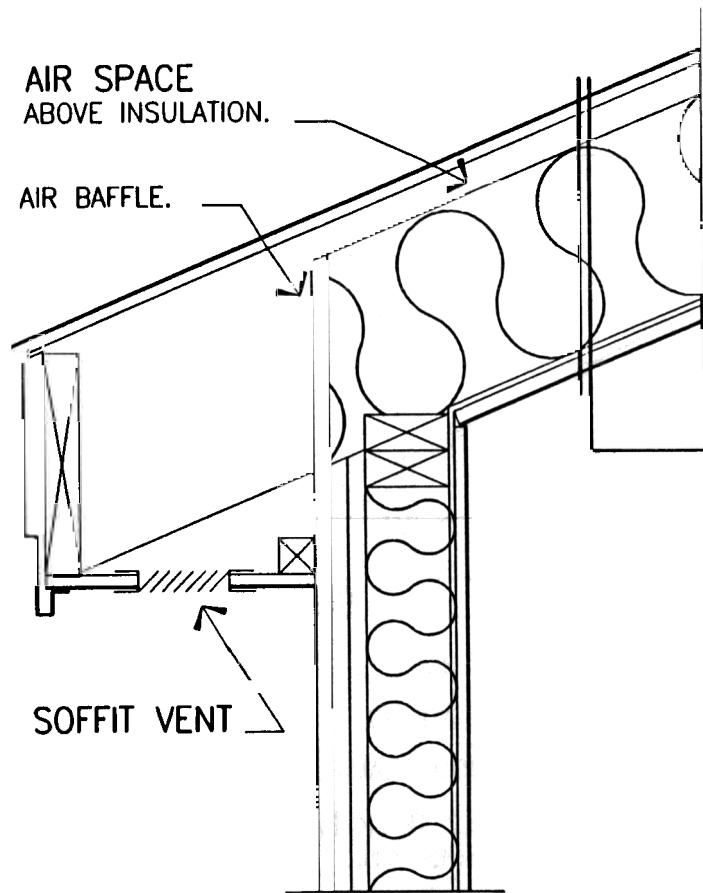

**QUESTION:** WHICH IS THE RECOMMENDED WAY TO INSULATE A ROOF RAFTER?

**ANSWER:** ACCORDING TO ASPHALT ROOFING SHINGLE MAKERS, THE ROOF SHINGLES MUST BE KEPT COOL. MOST DAMAGE OCCURS DURING THE SUMMER WHEN THE SUN BAKES THE ROOF. WITHOUT AN AIR SPACE TO DISSIPATE THE HEAT, THE SHINGLE LIFE COULD BE REDUCED BY AS MUCH AS 50%.

- ASPHALT SHINGLES.
- ROOFING FELT WITH ICE PROTECTION BARRIER.
- SHEATHING.
- AIR SPACE.
- ENGINEERED WOOD TRUSSES OR RAFTERS.
- INSULATION AS REQUIRED.
- VAPOR BARRIER.
- GYPSUM BOARD.

1

COLD ROOF ASSEMBLY

COLDROOF