

SECTION

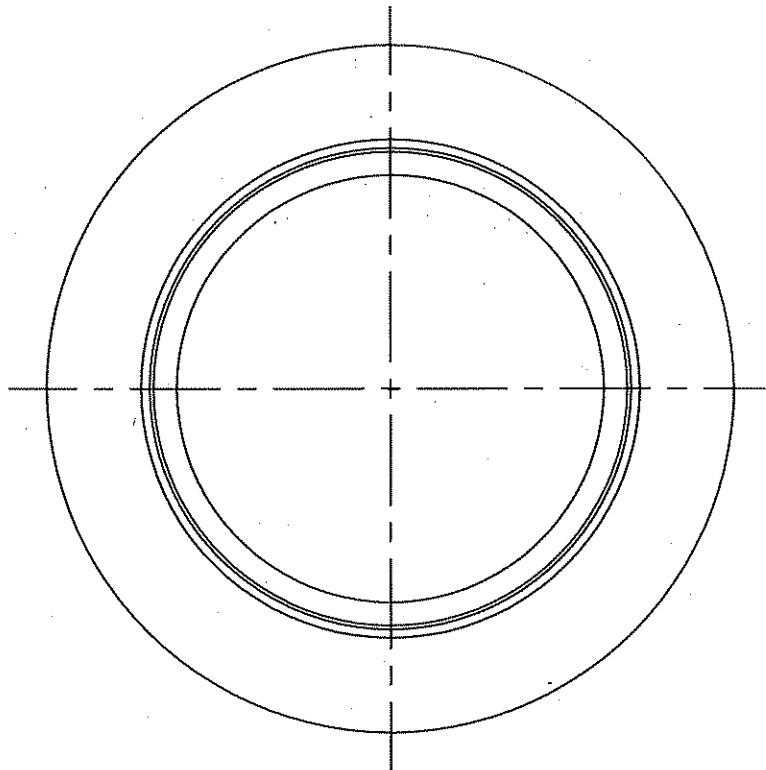

PLAN

NOTES:

1. FRAME CASTING 'A' TO BE USED WITH COVER CASTINGS 'B' OR 'D', SEE STANDARD PLATES 2202D AND 2203.
2. CASTING SHALL BE CONSTRUCTED OF UNPAINTED GRAY IRON MEETING ASTM-A-48, CLASS 35B OR BETTER AND SHALL CONFORM TO AASHTO DESIGNATION M306-89 AND MnDOT SPECIFICATION 3321.
3. THE MANUFACTURERS NAME SHALL BE CAST ON AN EXPOSED SURFACE OF THE CASTING.
4. CASTING SHALL BE NEENAH FOUNDRY CO. NO. R-1678-A OR APPROVED EQUAL.

I hereby certify that this plan, specification or report was prepared by me or under my direct supervision and that I am a duly Licensed Professional Engineer under the laws of the State of Minnesota.

*Joseph J. Mueller*  
 JOSEPH J. MUELLER

Date 5-4-10 Lic. No. 13942

APPROVED

*J. Mueller*  
 CITY ENGINEER

CITY OF ST. PAUL  
 DEPARTMENT OF PUBLIC WORKS

FRAME CASTING "A"

Date of  
 Revision

MAY  
 2010

Standard  
 Plate  
 No.

2201E