

# THE ROADWAY



Many segments of Summit Avenue have not been reconstructed since the 1930's, almost 100 years ago.

Over time, roadways need to be reconstructed to replace aging infrastructure, this includes underground utilities, roadway base structure and surface, lighting, curb & gutter and sidewalks.

## Improvements

### Near-Term (2-3 yr.)

- Surface: Mill & Overlay
- Crossings: Bump-Outs, Ramps
- Funded for construction

### Long-Term (Phased process, ~10-15+ yr)

- Roadway Reconstruction
- Regional Trail Facility
- NOT funded for construction



Roadway construction near Summit Avenue and Grotto, 1915 | Credit: Minnesota Historical Society

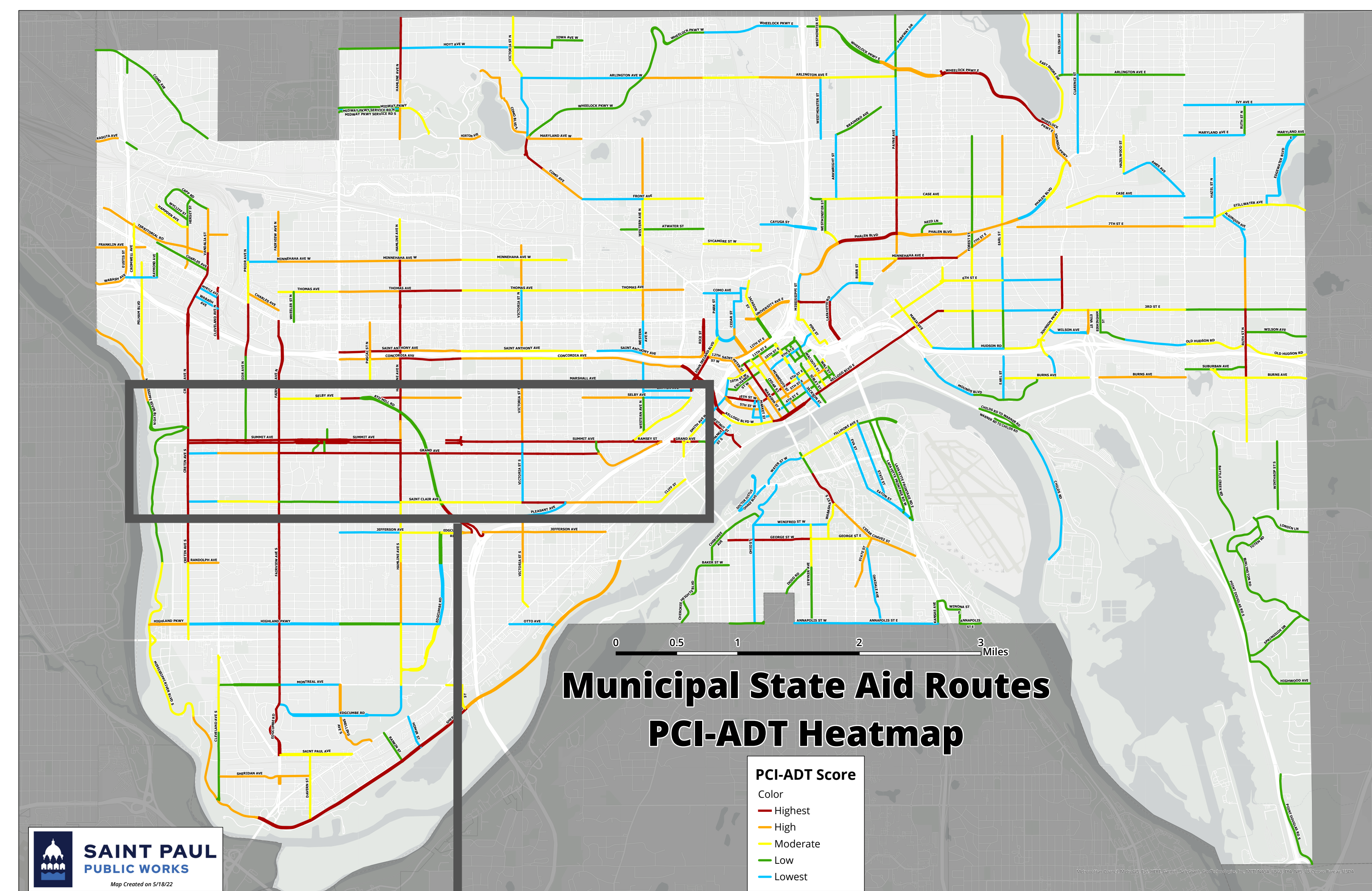

Pavement Condition Index (PCI) & Average Daily Traffic (ADT) Map

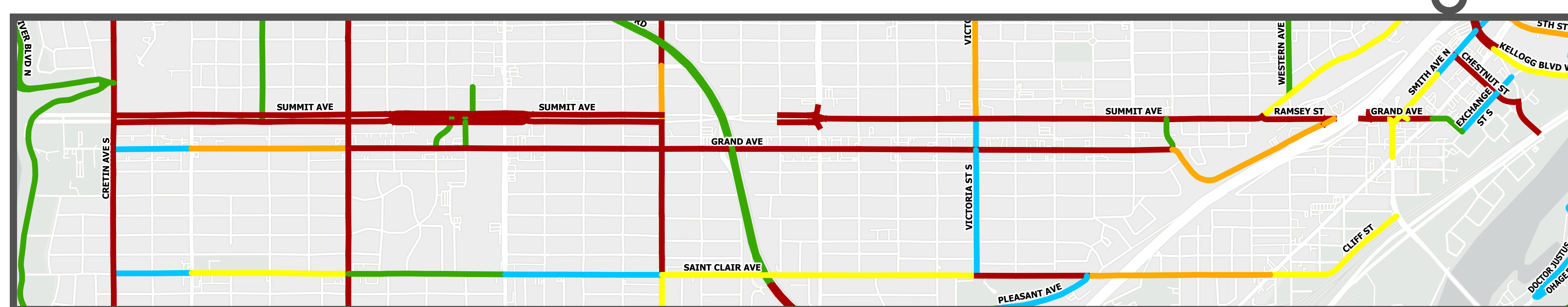

The map above reflects the relationship between pavement conditions and average daily traffic.

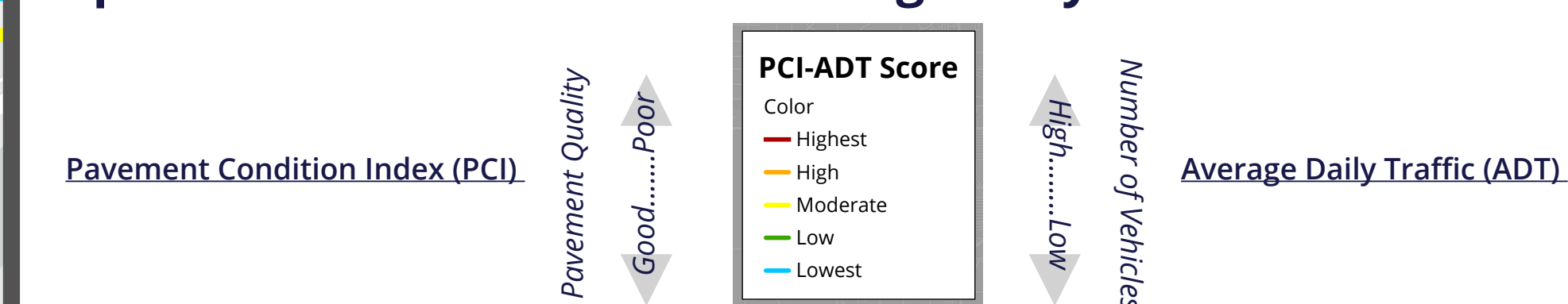

Summit Avenue scores highly across the City, reflecting a combination of both poor pavement conditions and high average daily traffic.

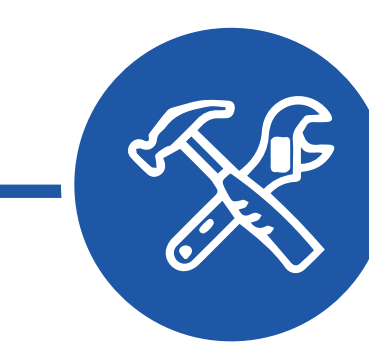

## ROADWAY Composition & Construction



2022 - 2023 Surface Improvements (Mississippi River Blvd to Victoria)

### SURFACE IMPROVEMENTS

Occurs every 8-10 years\*

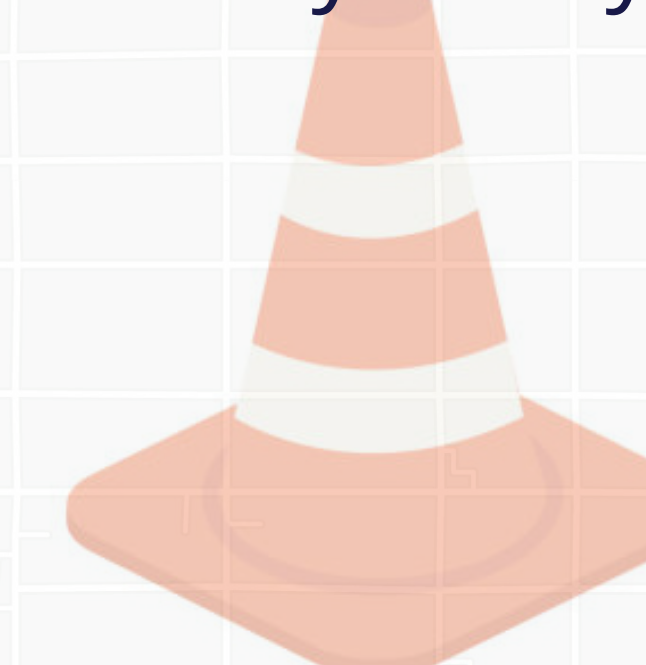

### STREET RECONSTRUCTION

Occurs every 50-100 years\*

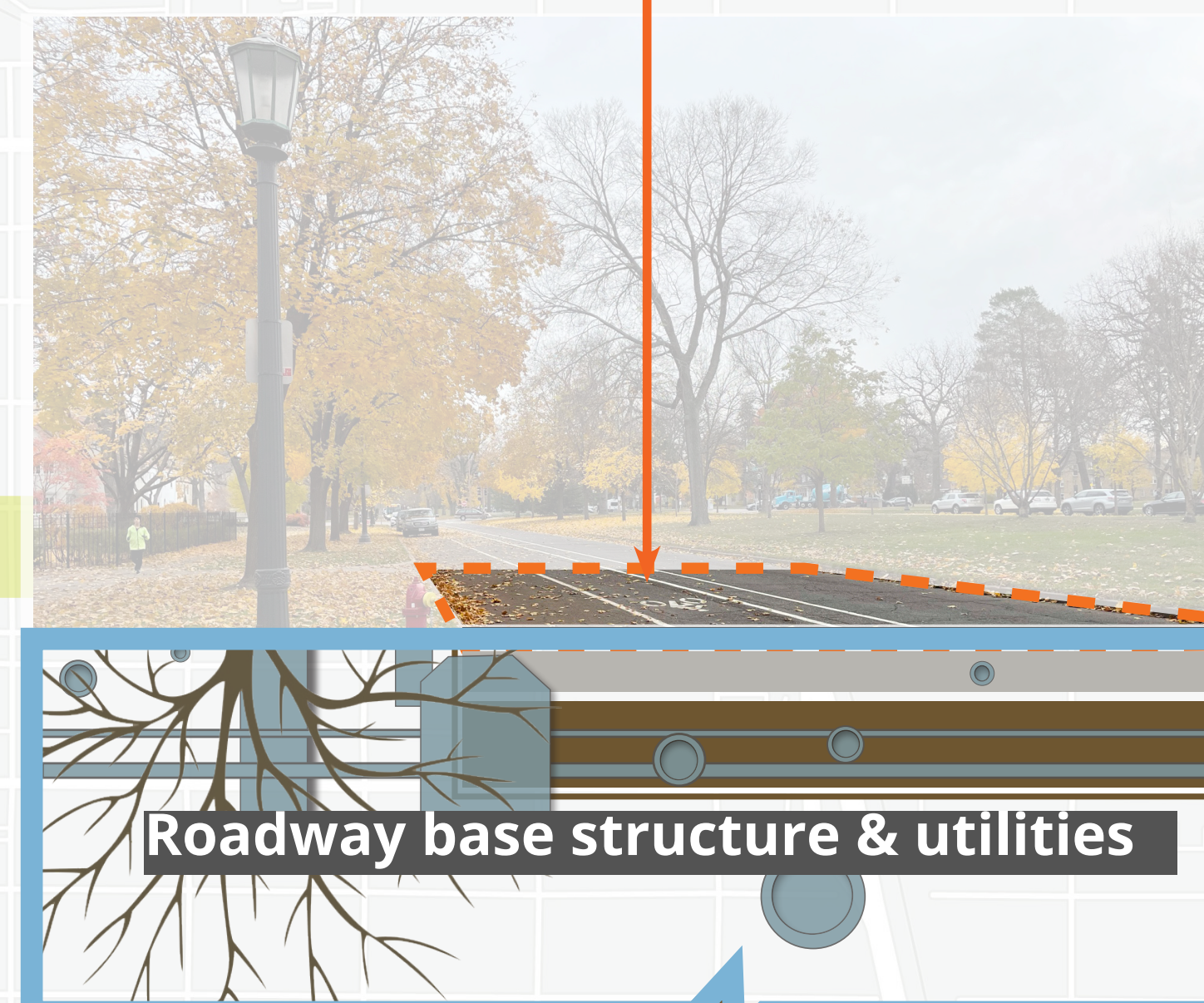

\*Specific scope and timing of roadway construction projects vary depending on existing conditions and funding availability

## How does this relate to a trail facility?

Reconstruction projects replace all elements of the road: the surface, curb, ramps, and utility infrastructure beneath the surface.

The most cost-effective opportunities to add pedestrian and bicycle improvements come when roads are being fully redesigned.

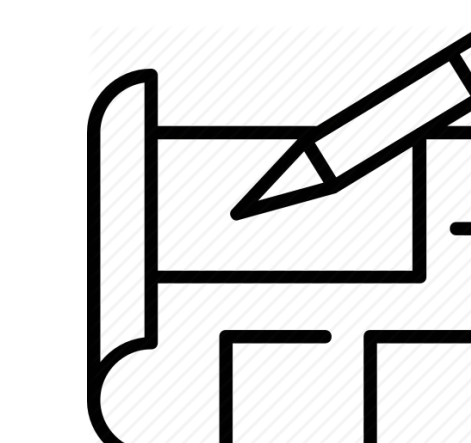

2022 mill & overlay and crossing improvements on Summit Avenue

